

# FLOOR PLAN

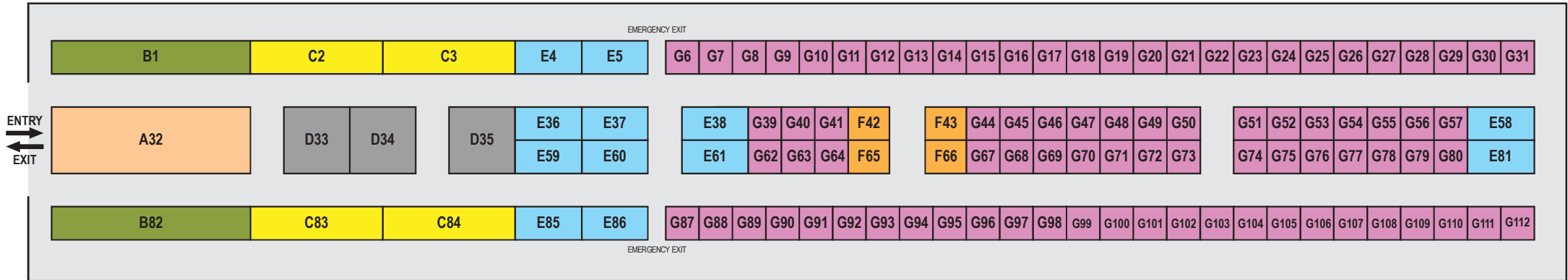

## Bombay Exhibition Centre Goregaon, Mumbai



### Stand Amenities

- Company Fascia Name
- White Modular Built-up Stand
- Panels (Back & Side Octonorm Walls)
- 1 Table, 2 Chairs, 2 Spotlights, Dustbin
- One Electric Point (5 Amp). Additional facilities at nominal extra charges.

### Cost Effective Stand Tariffs

These are early bird rates. Premium Stall Space & Shell scheme options are available  
Two options are available:  
Raw Non AC Spaces also available.  
Raw Space - Rs. 15,500 /- per sq.mtr  
Built up Stand - Rs. 16,000 /- per sq mt  
15 - 20 % Premium on Corner Stalls  
(18 % GST applicable on all payments).

### Legend

A	18 X 6 = 108 sq. Mtrs
B	18 X 3 = 54 sq. Mtrs
C	12 X 3 = 36 sq. Mtrs
D	6 X 6 = 36 sq. Mtrs
E	6 X 3 = 18 sq. Mtrs
F	4 X 3 = 12 sq. Mtrs
G	3 X 3 = 9 sq. Mtrs

\* Floor Plan Subject to Change

## Professional Producers



3 GUINNESS  
WR HOLDERS

PROMOTED BY



TRINITY  
ISO 9001:2015

Certified by



American National Standards Institute  
International Conformance Veritas



PATRON MEMBER  
EU INDIA CHAMBERS



ASSOCIATE  
MAHARATTA CHAMBER



IMPORT - EXPORT  
& HEALTH CHAMBER

+91 9769555657 | trinity.cmd@gmail.com